

# FORMAX® XXV

## Cold Forming Machine

### Product Overview

FORMAX XXV is a new 25 mm cutoff version of FORMAX. It combines the best features from small and large FORMAX like expanded die-space, high production speeds, pick-move-place transfer, zero clearance heading slide guiding, sealed heading slide liners, and precision linear feed, with all new technology including servo controlled adjustments and a robotic tool changer. This tool changer accesses an external setup fixture to make changes automatically without requiring a person to enter the die area of the machine. The XXV is available in short, medium and long strokes models with five, six, and seven dies.

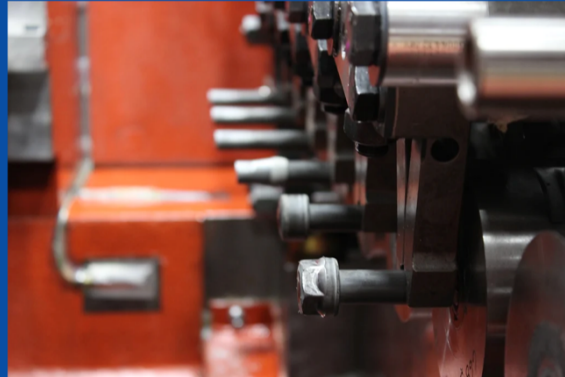

### Robotic Tool Change

The Robotic Tool changer accesses an external setup fixture to make changes automatically without requiring a person to enter the die area of the machine.

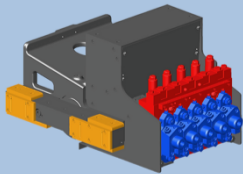

### **Zero-Clearance Heading Slide Guiding**

The Zero-Clearance Heading Slide is a 2-axis design that utilizes fixed liners that provide 'Zero Clearance' during the work stroke of the machine. Zero Clearance Heading Slide Guidance system precisely aligns punches to dies, and part concentricities are held to tolerances once thought impossible.

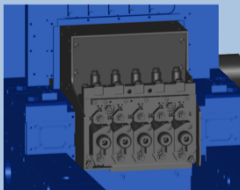

### **Sealed Heading Slide Liners**

FORMAX is the only Cold Forming machine designed with heading slide liners that are Sealed to prevent foreign materials from damaging the liners and causing excess/pre-mature wear.

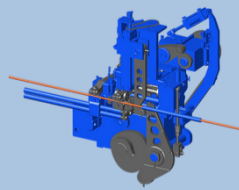

### **Precision Linear Feed**

Linear feeding obsoletes traditional feed roll designs with superior cut off blank accuracy without the need for a stock gauge. The linear feed grips are designed to handle the full range of wire diameters so only one set of grips is needed, unlike traditional feed rolls. Linear feed also delivers more precise blanks while eliminating the problems associated with feed clutches and brakes.

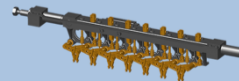

### **Pick-Move-Place Transfer**

Pick Move Place allows for excellent control of complex part shapes, and is ideal for head heavy, difficult to transfer parts. The extra wide finger opening capability clears larger punches.